



ProJoint™ PORCELAIN™ Primer

High performance priming slurry for porcelain paving

The ProJoint™ Porcelain™ Primer is an ultra-high polymer and fibre modified flexible primer with excellent workability and adhesion properties.

As a single coat fast application, ProJoint™ Porcelain™ Primer promotes adhesion and control suction on difficult substrates such as porcelain, concrete, ceramic tiles, paving slabs or setts. Using the ProJoint™ Porcelain™ Primer enables the porcelain slabs or setts to be laid on a sand and cement bedding.

The powdered primer is supplied in two 10kg bags, to allow the branded bucket to act as the ideal mixing vessel with the simple addition of water.



key facts



- Single coat application to the underside of paving
- Enables the paving to be laid on sand and cement bedding
- Excellent workability and adhesion properties
- Suitable for brush or roller application
- Can be applied in low temperatures
- Suitable for internal or external use
- Two x 10kg bags contained within the lidded mixing tub

order information

Item description:
ProJoint™ Porcelain™ Primer

Pack size: 20kg

Pallet quantity: 50 (can be combination of product/colour)

Order code:

- PP20

PLEASE NOTE: We recommend that ProJoint™ Porcelain™ Primer be used prior to laying paving and grouting porcelain paving with ProJoint™ Porcelain™ Grout.



application instructions & technical information overview

ProJoint™ Porcelain™ Primer is designed to be applied to the underside of porcelain paving and other low absorption substrates, to promote adhesion. The underside of the paving should be clean, dry and free of any material which may impair adhesion. **Do not apply to shiny surfaces.** ProJoint™ Porcelain™ Primer should not be used in wet weather and/or if frost is forecast within 24 hours of application. Suitable for use in temperatures between 3°C and 25°C.

preparation

ProJoint™ Porcelain™ Primer should be mixed with 2.8 litres of cold clean water per 10kg bag.

- 1 Remove the bags from the branded bucket and add the water to the bucket.
- 2 Add the powder slowly and mix using a plasterers' whisk.
- 3 Mix for 2 minutes.
- 4 Leave to stand for 2 minutes. **This is important as the process allows the polymer additives to dissolve and activate.**
- 5 Re-mix for a further 2 minutes.

application

- 6 When wearing appropriate PPE, **apply a thorough and even coat** of the primer as a slurry using a masonry brush or roller to the underside of the paving. The pot life of the mixed slurry is approximately 60 minutes at 20°C. **The primer should be completely dry prior to laying the paving.** Depending on the temperature and moisture, the primer will be dry within 10 to 15 minutes, however the primed slabs can be left undercover and dry for up to 2 weeks prior to laying.

All tools should be washed out with water immediately after use. Waste material should not be emptied into drainage systems.

coverage

Approximate coverage per 20kg tub is 25m² depending on the application method and paving porosity.

Frequently asked questions...

Q: Can the slabs be primed and left until ready to lay?

A: Yes, we recommend the primer is dry before laying the flags - once primed, they can be left for up to 2 weeks prior to laying.

Q: How strong is the ProJoint™ Porcelain Primer?

A: The primer has fantastic adhesion properties if the porcelain has to be lifted for any reason it will bring up the mortar bed with it.

Q: Why can't I use the ProJoint™ SBR for porcelain flags?

A: SBR would only be recommended for natural stone and concrete.

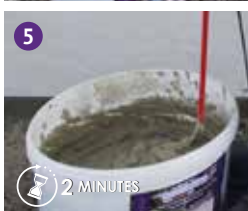

For storage and health and safety information - a full datasheet is available on request.